

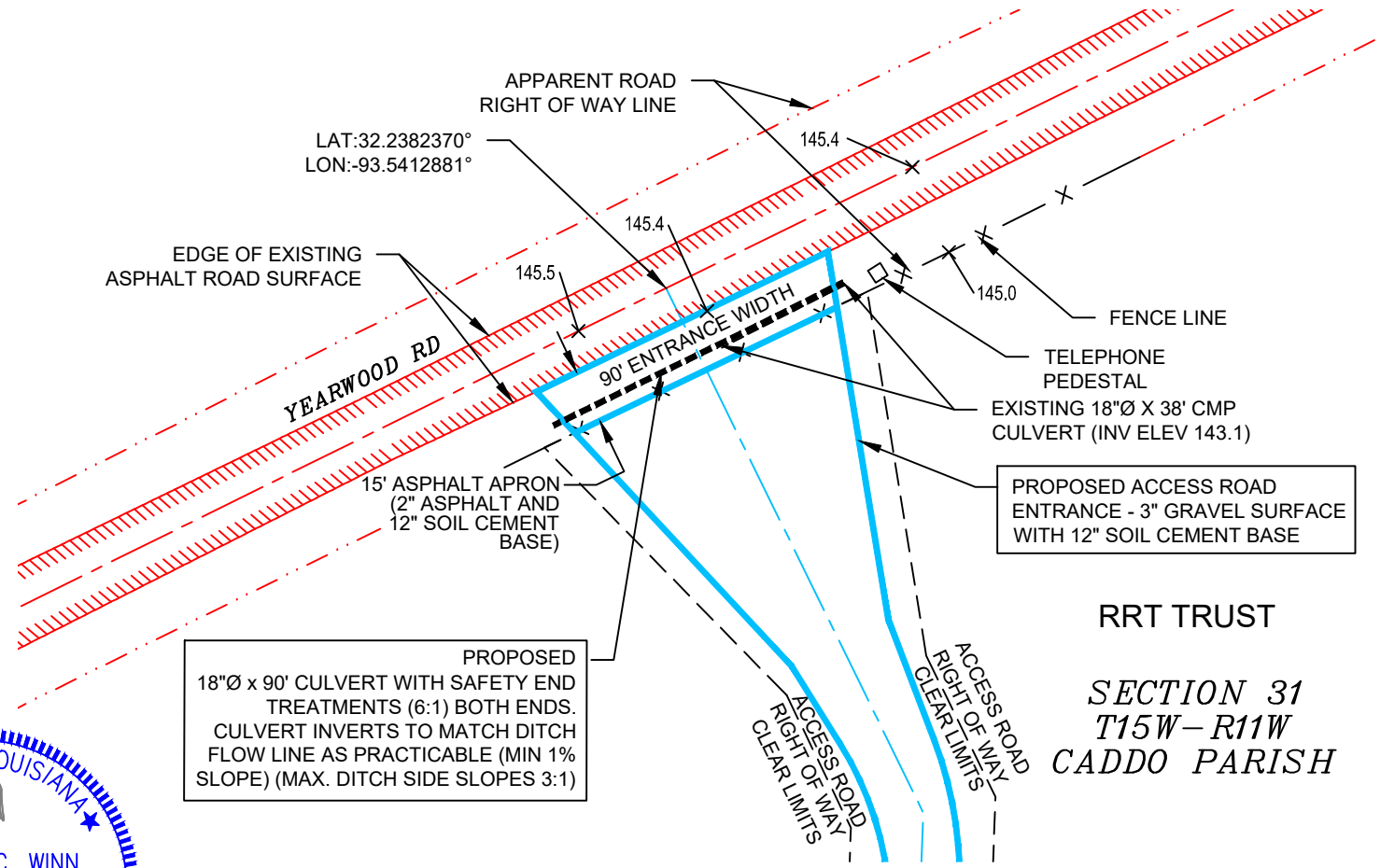

TOWNSHIP 15 NORTH, RANGE 11 WEST,  
CADDO PARISH, LOUISIANA



RRT TRUST  
SECTION 31  
T15W-R11W  
CADDO PARISH

PLAT SHOWING:  
**PROPOSED ACCESS ROAD  
ENTRANCE DETAIL**  
ADAMAS ENERGY LLC  
RRT Trust 6-7-18 and 6H Wells  
Located in the SW 1/4 of the SW 1/4,  
SECTION 31 T15N-R11W,  
CADDO PARISH, LOUISIANA  
March 10, 2026



I hereby certify that this plat accurately reflects this drill site access entrance as surveyed on the ground.  
*Benjamin C. Winn* 3/10/2026  
Benjamin C. Winn, P.E., P.L.S. (LA Reg. No. 4778) Date:  
Winn Surveying & Engineering, L.L.C.  
Springhill, LA 71075 (318) 423-5325



NOTE: This plat does not represent a Property Boundary Survey, Route Survey or Unitization Survey and therefore does not comply with the applicable standards of practice stipulated in LAC Title 46:LXI, Chapter 29, Standards of Practice for Boundary Surveys as currently adopted by the Louisiana Professional Engineering and Land Surveying Board.

TOWNSHIP 14 NORTH, RANGE 11 WEST,  
RED RIVER PARISH, LOUISIANA



HA RA SUH; RRT Trust 6-7-18LHC No. 1-ALT	
X =	1,678,619.38
Y =	572,244.72
LAT.	32°14'08.20" N
LONG.	93°32'21.80" W
NAD 27 - LA North Zone	
CALLS - 693' FNL 1061' FWL	
Ground Elev.: 146' NAVD88	

HA RA SUH; RRT Trust 6-7-18HC No. 2-ALT	
X =	1,678,630.83
Y =	572,222.50
LAT.	32°14'07.98" N
LONG.	93°32'21.67" W
NAD 27 - LA North Zone	
CALLS - 715' FNL 1073' FWL	
Ground Elev.: 146' NAVD88	

HA RA SUH; RRT Trust 6H No. 1-ALT	
X =	1,678,642.29
Y =	572,200.27
LAT.	32°14'07.76" N
LONG.	93°32'21.53" W
NAD 27 - LA North Zone	
CALLS - 737' FNL 1085' FWL	
Ground Elev.: 146' NAVD88	

PLAT SHOWING:  
AS-STAKED DRILL SITE FOR WELL LOCATIONS  
AETHON ENERGY OPERATING LLC  
HA RA SUH; RRT TRUST 6-7-18 AND 6H WELLS

Located in the NW 1/4,  
SECTION 6, T14N-R11W,  
RED RIVER PARISH, LOUISIANA  
March 3, 2026

**NOTE:** This plat does not represent a Property Boundary Survey, Route Survey or Unitization Survey and therefore does not comply with the applicable standards of practice stipulated in LAC Title 46:LXI, Chapter 29, Standards of Practice for Boundary Surveys as currently adopted by the Louisiana Professional Engineering and Land Surveying Board.



I hereby certify that this plat accurately reflects this drill site as staked on the ground

*Benjamin C. Winn* 3/03/2026  
Benjamin C. Winn, P.E., P.L.S. (LA Reg. No. 4778) Date:  
Winn Surveying & Engineering, L.L.C.  
Springhill, LA 71075 (318) 423-5325

Bearings are based on Grid North (SPCS-LA-N-NAD83)

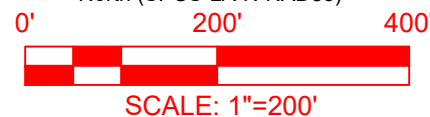

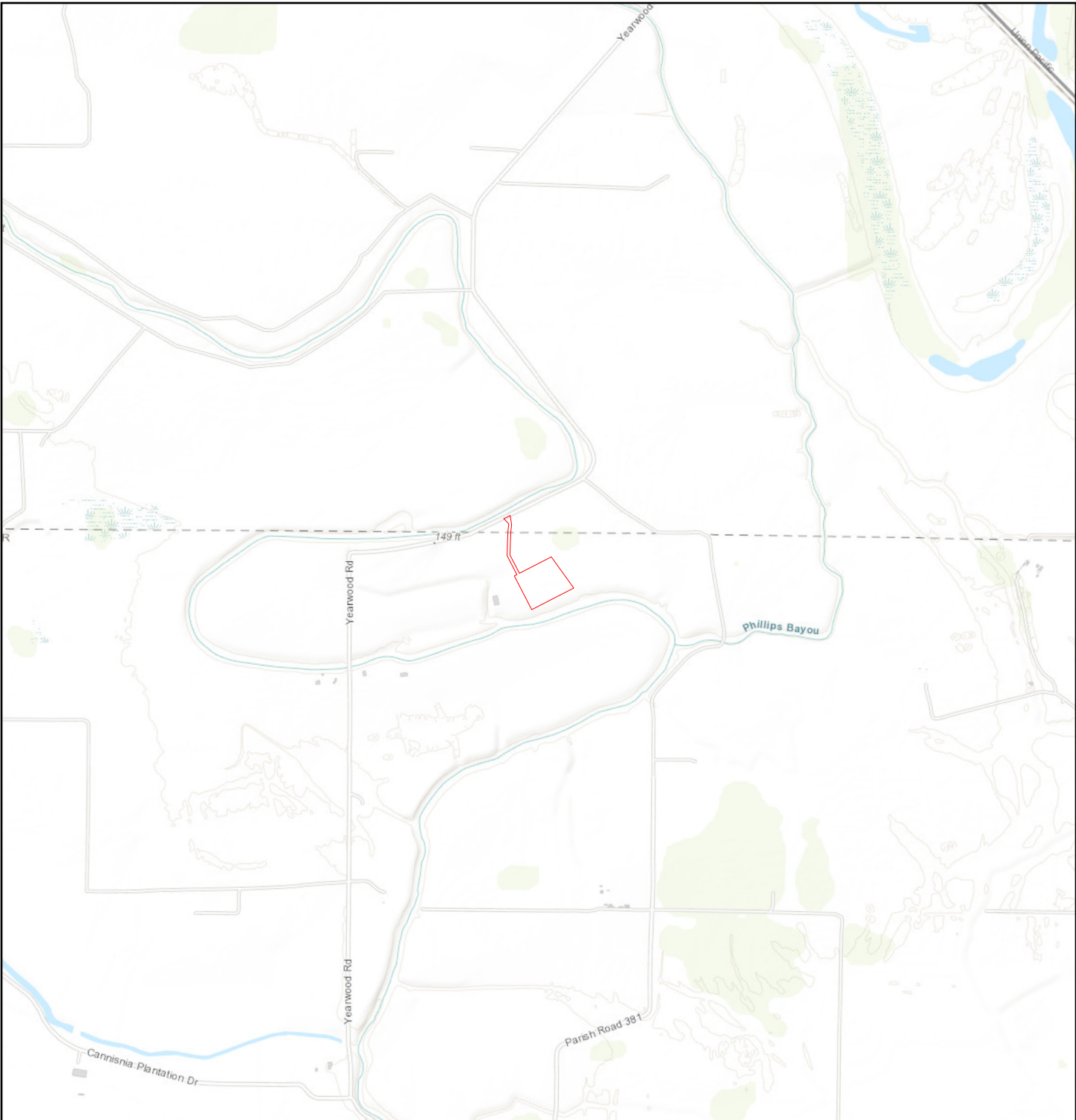

**Figure 1 - Vicinity Map  
 RRT Trust Sec 6-3 Drill Pad and Access Road  
 Adamas Energy, LLC  
 Caddo & Red River Parish, Louisiana**

**Legend**

Proposed Well Site & Access Road



**132 Lone Oak Dr.  
 Benton, LA 71006**

Prepared By: Matthew Williams

Date: Mar 16, 2026

